



Superior Clamping and Gripping



Product Information

Flat swivel unit RM-F

RM-F

Flat swivel unit

Modular. Rapid. Productive.

Small swivel unit RM-f

Lightweight pneumatic unit for fast swiveling tasks

Field of application

Can be used in clean to slightly dirty environments such as assembly or packaging areas, or wherever fast movement cycles are required.



Advantages – Your benefits

Continuous angle of rotation adjustment over the entire range of rotation

Double piston principle for scope-free end positions and high repeat accuracy

Integrated shock absorbers with adjustable absorption characteristics for optimal damping

“Continuously adjustable intermediate position” option can be done using an intermediate stop which can be integrated

Choice of electronic magnetic sensors or inductive proximity sensors for absolute variability of position monitoring

Standardized mounting bores for numerous combinations with other components from the modular system



Sizes
Quantity: 6



Weight
0.046 .. 1.6 kg



Torque
0.05 .. 1.9 Nm



Repeat accuracy
0.082 .. 0.15°



Angle of rotation
185 .. 190°

Functional description

When subjected to pressure, the two pneumatic pistons move their end faces in a straight line in their respective bores thus turning the pinion by means of the serrations on their sides.

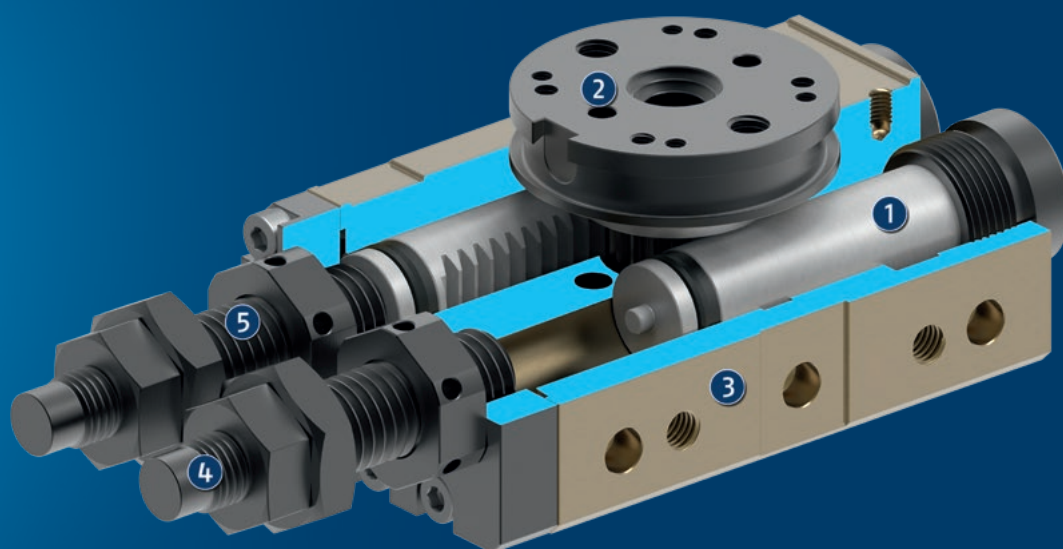

- ① **Drive**
Pneumatic, powerful double piston drive
- ② **Kinematics**
Rack and pinion principle for a reduced backlash transmission of the driving force into the rotary motion
- ③ **Mounting pattern**
Completely integrated in the module system
- ④ **End position damping**
Adjusting of the damping characteristics by adjusting the damper stroke
- ⑤ **Swivel angle adjustment**
for flexible end position

General notes about the series

Housing material: Aluminum alloy, anodized

Actuation: pneumatic, with filtered compressed air as per ISO 8573-1:2010 [7:4:4].

Operating principle: Double piston rack and pinion principle

Scope of delivery: Completely ready for operation without bracket for proximity switch and without proximity switch

Warranty: 24 months

Repeat accuracy: is defined as a distribution of the end position for 100 consecutive cycles.

Pinion position: is always shown in the left end position. The pinion rotates from here to the right in clockwise direction. The arrow makes the direction of rotation clear.

Pinion screw connection diagram: When setting a swivel angle smaller than 90° , the left end stop must be completely turned in. This means that the left end position has a screw connection diagram on the pinion which is clockwise turned by 90° compared to the main view, which shows a swivel angle of 180° .

Layout or control calculation: For configuration or control calculation of the units, we recommend to use our Toolbox software, which is available online. A control calculation for the selected unit must be carried out to prevent overloading.

Application example

Pneumatic loading and unloading with three swivel units for small workpieces

- ❶ Gripper for small components MPC
- ❷ Swivel unit RM-F
- ❸ Linear module LM
- ❹ Pillar assembly system

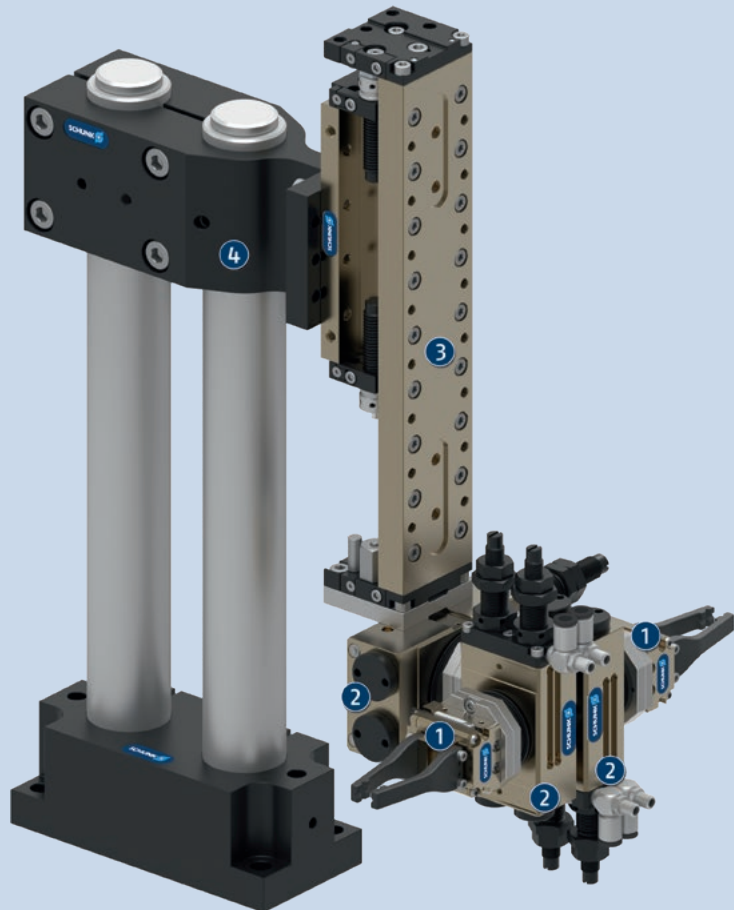

SCHUNK offers more ...

The following components make the product even more productive – the suitable addition for the highest functionality, flexibility, reliability, and controlled production.



Gripper for small components



Rotary gripper module



Linear module



Pick & Place Unit



Magnetic switches



Pressure maintenance valve



Intermediate stop



Pillar assembly system



Inductive proximity switches



Fastened with screws

① For more information on these products can be found on the following product pages or at schunk.com.

Options and special information

Version with intermediate position RZ: By mounting two pneumatically actuated cylinders, an intermediate position can be implemented, which can be flexibly adjusted over the entire swivel range.

Modular system: As standard, this module can be combined with numerous components from the modular system. We would be happy to assist you.

RM-F 6

Flat swivel unit



Max. permissible inertia J*

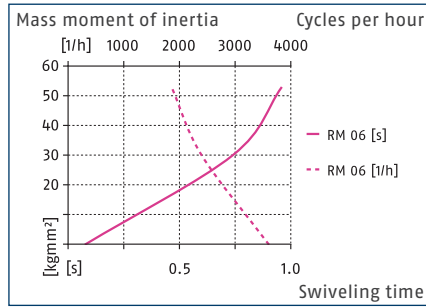

* The diagrams are valid for basic units and for applications with a vertical swivel axis as well as for absolutely centric loads with a horizontal swivel axis and with an operating pressure of 6 bar. The swiveling times per throttling have to be observed, otherwise the life time may reduce. We will be happy to help you designing other applications. In addition, the SCHUNK Design Tool Swiveling is available online.

Dimensions and maximum loads

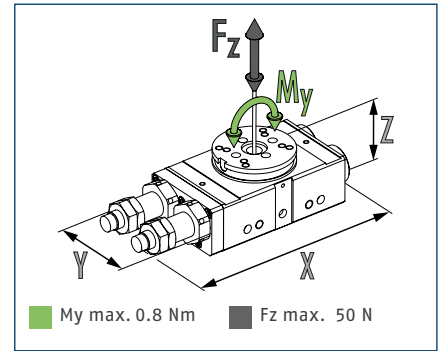

① The indicated moments and forces are static values and may appear simultaneously. Throttling has to be done for ensuring that the rotary movement takes place without impact or bouncing. Otherwise the service life reduces.

Technical data

Description		RM 06
ID		0313017
Angle of rotation	[°]	185.0
End position adjustability	[°]	90.0
Torque	[Nm]	0.05
Number of intermediate positions		none
IP protection class		40
Weight	[kg]	0.046
Fluid consumption (2x nom. angle)	[cm³]	0.656
Min./nom./max. operating pressure	[bar]	3/6/8
Min./max. ambient temperature	[°C]	5/60
Repeat accuracy	[°]	0.082
Dimensions X x Y x Z	[mm]	77.6 x 18 x 19

① For configuration of swivel modules, we recommend to use our Toolbox software, which is available online. Verifying the sizing of the selected unit is absolutely necessary, as otherwise overloading may occur.

Main view

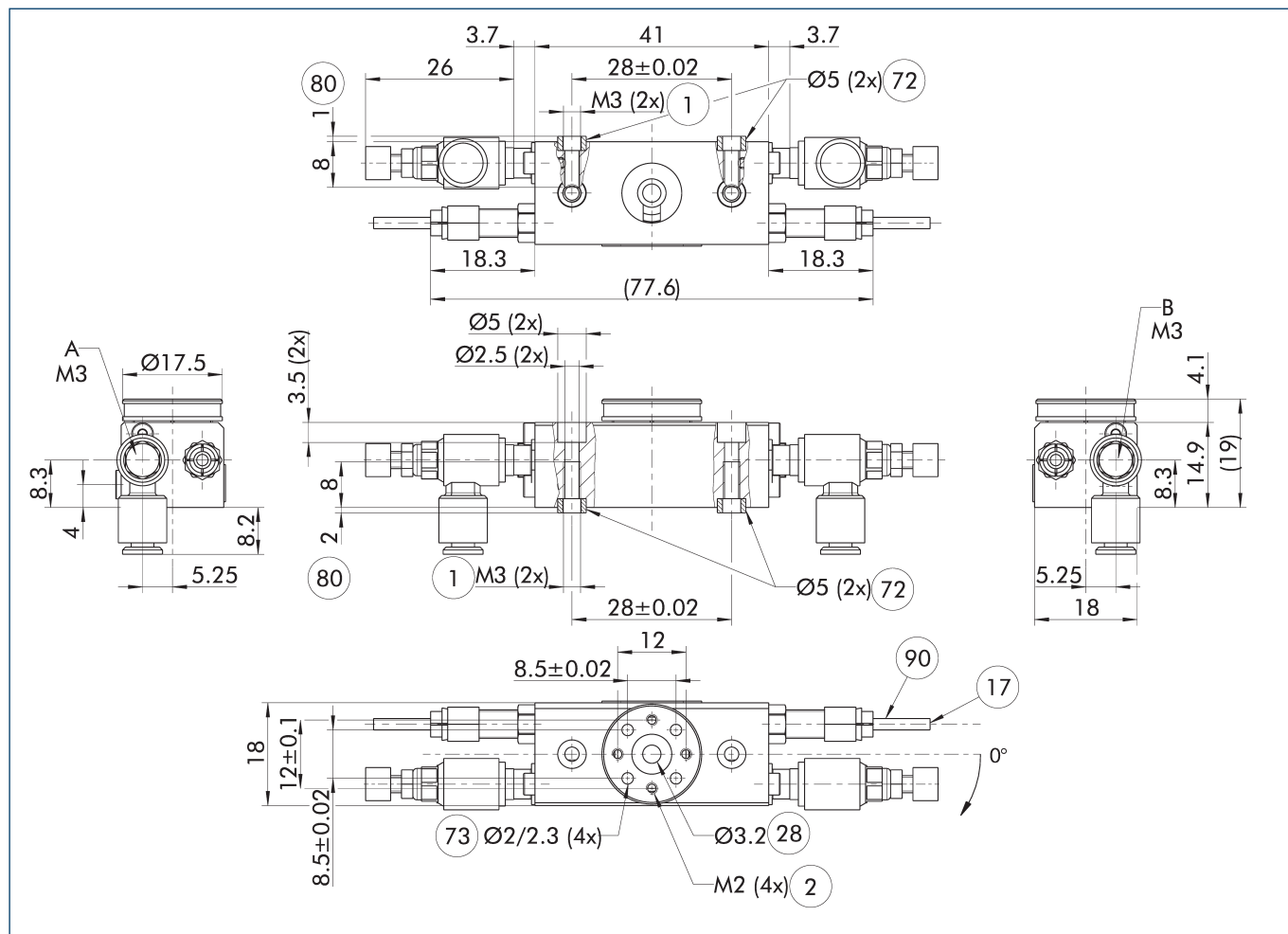

The drawing shows the unit in standard design, without considering any dimensions of the options described below.

- ① The SDV-P pressure maintenance valve can be used to maintain the position in the case of a loss of pressure (see "Accessories" catalog section).

A, a Main / direct connection, rotary actuator rotates clockwise

B, b Main / direct connection, rotary actuator rotates counterclockwise

- ① Connection swivel unit
- ② Attachment connection

①7 Cable outlet

②8 Through-hole

⑦2 Fit for centering sleeves

⑦3 Fit for centering pins

⑧0 Depth of the centering sleeve hole in the counter part

⑨0 Inductive proximity switches

Inductive proximity switches

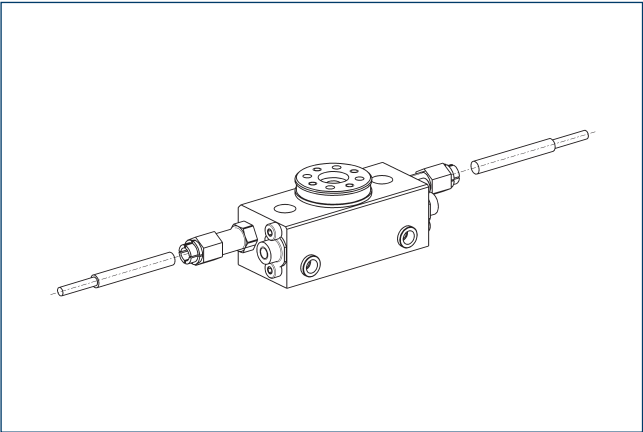

The end-position monitoring is directly possible on the unit by using inductive proximity switches.

Description	ID	Often combined
Inductive proximity switches		
IN 30L-S-M8-PNP	1001274	
Connection cables		
KA BG08-L 3P-0300-PNP	0301622	●
KA BG08-L 3P-0500-PNP	0301623	
KA BW08-L 3P-0300-PNP	0301594	
KA BW08-L 3P-0500-PNP	0301502	
clip for plug/socket		
CLI-M8	0301463	
Cable extension		
KV BW08-SG08 3P-0030-PNP	0301495	
KV BW08-SG08 3P-0100-PNP	0301496	
KV BW08-SG08 3P-0200-PNP	0301497	●
Sensor distributor		
V2-M8	0301775	●
V4-M8	0301746	
V8-M8	0301751	

ⓘ In general, two sensors are required per swivel unit as well as the optional extension cables.

RM-F 8

Flat swivel unit



Max. permissible inertia J*

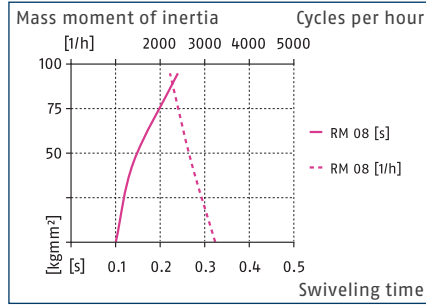

* The diagrams are valid for basic units and for applications with a vertical swivel axis as well as for absolutely centric loads with a horizontal swivel axis and with an operating pressure of 6 bar. The swiveling times per throttling have to be observed, otherwise the life time may reduce. We will be happy to help you designing other applications. In addition, the SCHUNK Design Tool Swiveling is available online.

Dimensions and maximum loads

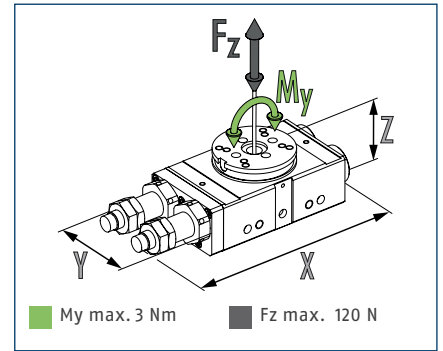

① The indicated moments and forces are static values and may appear simultaneously. Throttling has to be done for ensuring that the rotary movement takes place without impact or bouncing. Otherwise the service life reduces.

Technical data

Description		RM 08
ID		0313018
Angle of rotation	[°]	185.0
End position adjustability	[°]	90.0
Torque	[Nm]	0.107
Number of intermediate positions		none
IP protection class		40
Weight	[kg]	0.091
Fluid consumption (2x nom. angle)	[cm³]	1.4
Min./nom./max. operating pressure	[bar]	3/6/8
Min./max. ambient temperature	[°C]	5/60
Repeat accuracy	[°]	0.084
Dimensions X x Y x Z	[mm]	90.6 x 22 x 25.5

① For configuration of swivel modules, we recommend to use our Toolbox software, which is available online. Verifying the sizing of the selected unit is absolutely necessary, as otherwise overloading may occur.

Main view

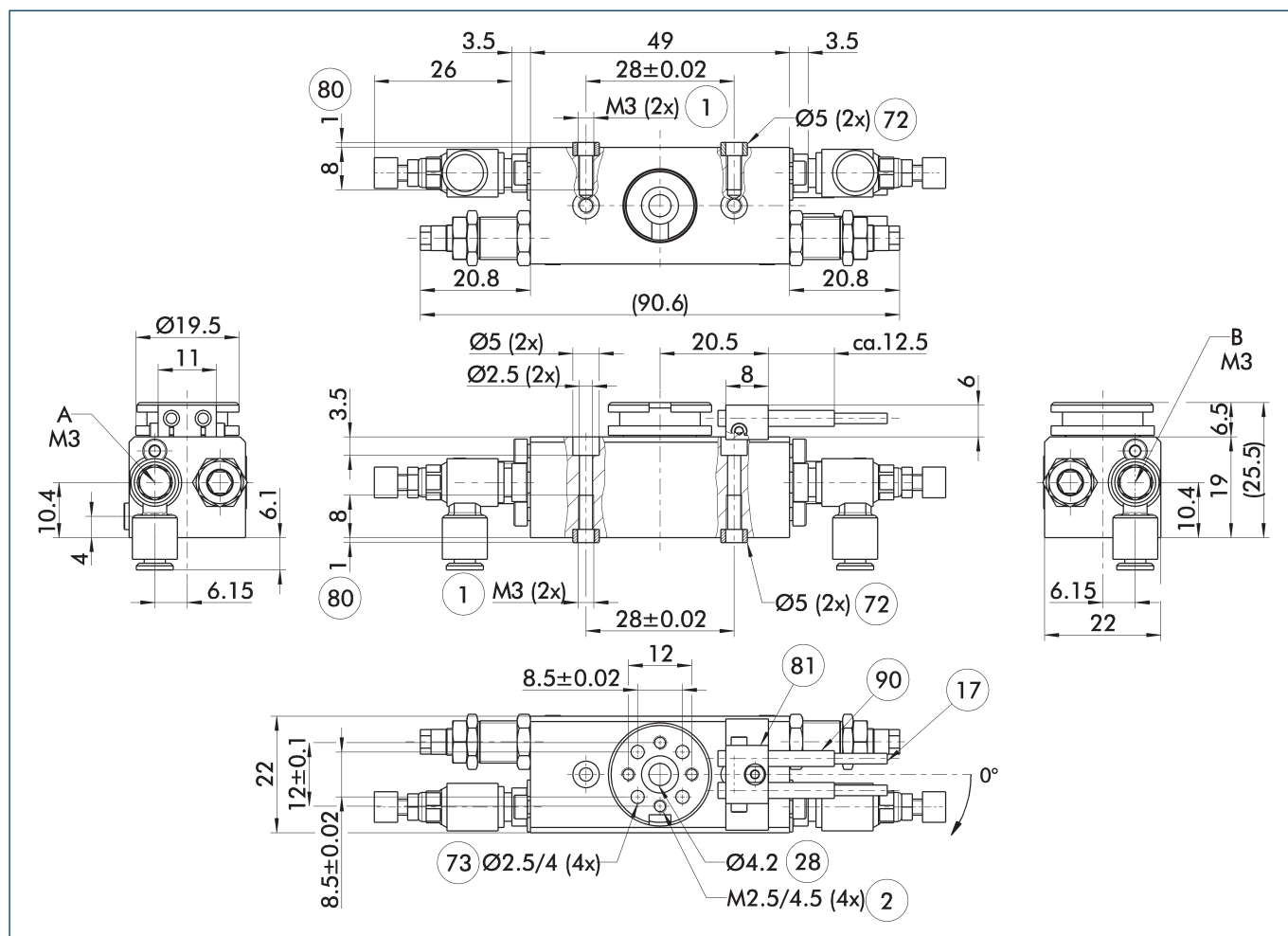

The drawing shows the unit in standard design, without considering any dimensions of the options described below.

- ① The SDV-P pressure maintenance valve can be used to maintain the position in the case of a loss of pressure (see "Accessories" catalog section).

A, a Main / direct connection, rotary actuator rotates clockwise

B, b Main / direct connection, rotary actuator rotates counterclockwise

- ① Connection swivel unit
- ② Attachment connection
- ①⑦ Cable outlet

②⑧ Through-hole

⑦② Fit for centering sleeves

⑦③ Fit for centering pins

⑧① Depth of the centering sleeve hole in the counter part

⑧① Not included in the scope of delivery

⑨① Inductive proximity switches

RM-F 8

Flat swivel unit

Inductive proximity switches

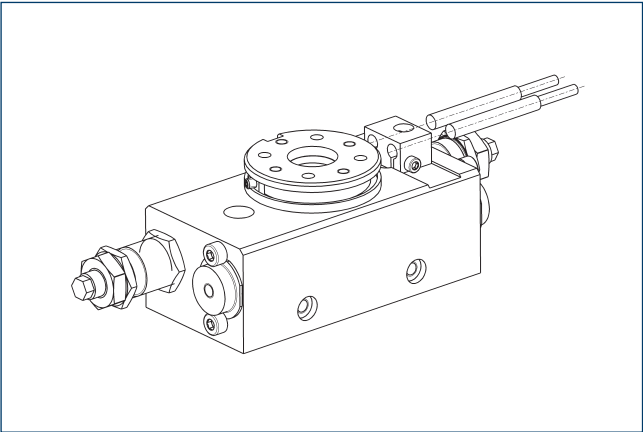

The end-position monitoring can be directly mounted on the unit by using inductive proximity switches.

Description	ID	Often combined
Inductive proximity switches		
RMNS 08-G	1353702	●
RMNS 08-W	1353720	
RMNS 08-X	1353736	
clip for plug/socket		
CLI-M8	0301463	

- ① The RMNS set includes two sensors with 30 cm cable length to M8 connector, two switching cams, and a sensor bracket. The versions -G/-W comprise a 5 m long connection cable with straight (-G) or angular (-W) plug connector to open cable end.

RM-F 10

Flat swivel unit



Max. permissible inertia J*

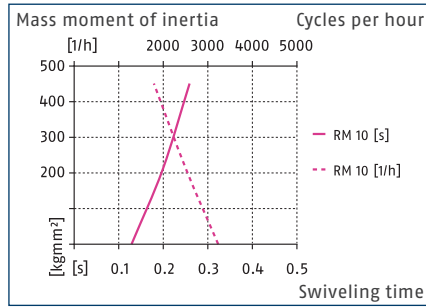

* The diagrams are valid for basic units and for applications with a vertical swivel axis as well as for absolutely centric loads with a horizontal swivel axis and with an operating pressure of 6 bar. The swiveling times per throttling have to be observed, otherwise the life time may reduce. We will be happy to help you designing other applications. In addition, the SCHUNK Design Tool Swiveling is available online.

Dimensions and maximum loads

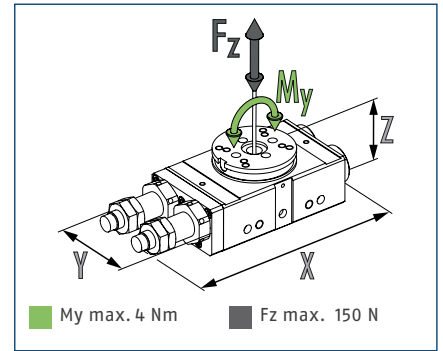

① The indicated moments and forces are static values and may appear simultaneously. Throttling has to be done for ensuring that the rotary movement takes place without impact or bouncing. Otherwise the service life reduces.

Technical data

Description		RM 10
ID		0313019
Angle of rotation	[°]	185.0
End position adjustability	[°]	90.0
Torque	[Nm]	0.224
Number of intermediate positions		none
IP protection class		40
Weight	[kg]	0.178
Fluid consumption (2x nom. angle)	[cm³]	2.9
Min./nom./max. operating pressure	[bar]	3/6/8
Min./max. ambient temperature	[°C]	5/60
Repeat accuracy	[°]	0.088
Dimensions X x Y x Z	[mm]	106 x 30 x 28.5

① For configuration of swivel modules, we recommend to use our Toolbox software, which is available online. Verifying the sizing of the selected unit is absolutely necessary, as otherwise overloading may occur.

Main view

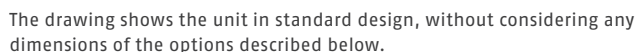

- ⑨0 Inductive proximity switches

Inductive proximity switches

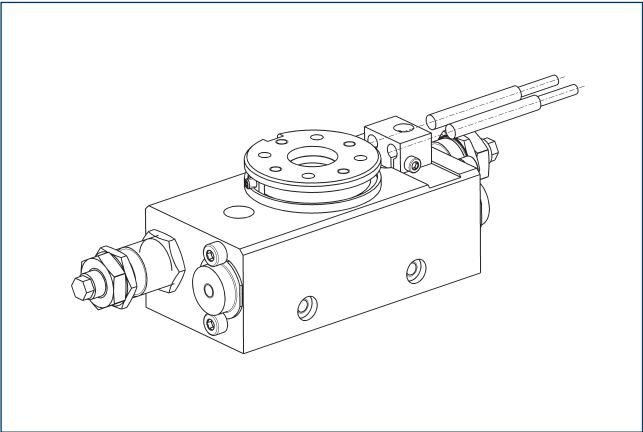

The end-position monitoring can be directly mounted on the unit by using inductive proximity switches.

Description	ID	Often combined
Inductive proximity switches		
RMNS 08-G	1353702	●
RMNS 08-W	1353720	
RMNS 08-X	1353736	
clip for plug/socket		
CLI-M8	0301463	

- ① The RMNS set includes two sensors with 30 cm cable length to M8 connector, two switching cams, and a sensor bracket. The versions -G/-W comprise a 5 m long connection cable with straight (-G) or angular (-W) plug connector to open cable end.

RM-F 12

Flat swivel unit



Max. permissible inertia J*

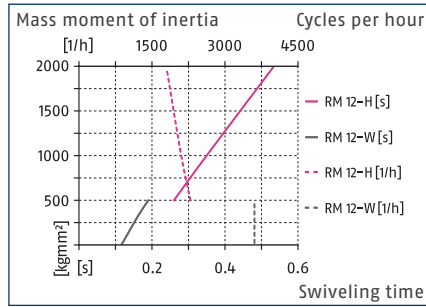

* The diagrams are valid for basic units and for applications with a vertical swivel axis as well as for absolutely centric loads with a horizontal swivel axis and with an operating pressure of 6 bar. The swiveling times per throttling have to be observed, otherwise the life time may reduce. We will be happy to help you designing other applications. In addition, the SCHUNK Design Tool Swiveling is available online.

Dimensions and maximum loads

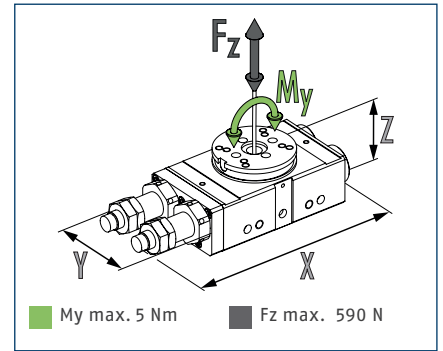

① The indicated moments and forces are static values and may appear simultaneously. Throttling has to be done for ensuring that the rotary movement takes place without impact or bouncing. Otherwise the service life reduces.

Technical data

Description		RM 12-W	RM 12-W-RZ	RM 12-H	RM 12-H-RZ
ID		1348062	1380163	0313000	0313013
Angle of rotation	[°]	190.0	190.0	190.0	190.0
End position adjustability	[°]	90.0	90.0	90.0	90.0
Torque	[Nm]	0.38	0.38	0.38	0.38
Number of intermediate positions		none	1 x M (pneumatic)	none	1 x M (pneumatic)
Adjustability of middle position	[°]		190.0		190.0
IP protection class		40	40	40	40
Weight	[kg]	0.36	0.48	0.36	0.48
Fluid consumption (2x nom. angle)	[cm³]	4.8	4.8	4.8	4.8
Min./nom./max. operating pressure	[bar]	3/6/8	3/6/8	3/6/8	3/6/8
Min./max. ambient temperature	[°C]	5/60	5/60	5/60	5/60
Max. permissible mass moment of inertia of the set-up	[kgm²]		0.00045		0.00045
Repeat accuracy	[°]	0.098	0.15	0.098	0.15
Repeat accuracy (difference of both directions)	[°]		0.35		0.35
Dimensions X x Y x Z	[mm]	122 x 43 x 35	122 x 43 x 35	122 x 43 x 35	122 x 43 x 35

① For configuration of swivel modules, we recommend to use our Toolbox software, which is available online. Verifying the sizing of the selected unit is absolutely necessary, as otherwise overloading may occur.

Technical drawings of the 3000 series solenoid valve, showing front, side, and top views with dimensions and part numbers.

Front View (Top): Dimensions include 73, Ø5/4 (2x), 34, 25, M4/6 (4x), M5/6 (4x), 1, 22, 21.3, Ø20.05/0.7, and 25±0.02.

Side View (Middle): Dimensions include 15.6, 21.2, 73, Ø5/4, Ø10/1 (78), Ø6.5 (28), Ø5/3.5 (2x) (73), 7.5, 34, 50±0.02, 1, M5/6 (2x), and 2.

Top View (Bottom): Dimensions include 4, M5 (2x), 6.9, 10.2, 8.5, 17, 90, 10, 32.5, ca. 45, 81, 22.6, 22, 16, Ø3/4 (2x) (73), M3/7 (4x) (2), 20±0.02, 18, 22, 0°, 21.2, 8, 25, 34, M2.5/6 (4x) (2), 45, 76, 5, and 126.

⑨ Inductive proximity switches

Intermediate position, RZ

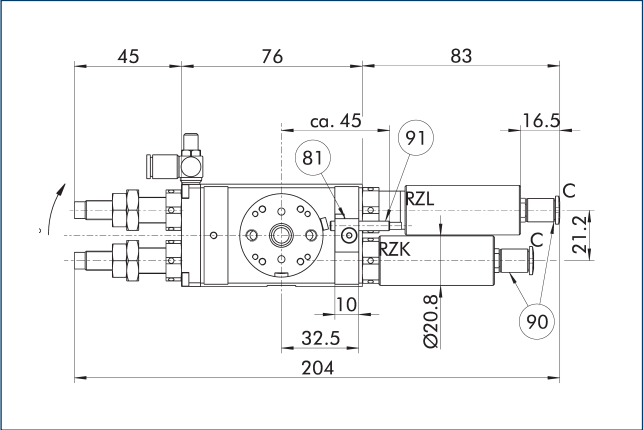

- 81 Not included in the scope of delivery

90 additional air connection "C" for intermediate position

91 Inductive proximity switches
- The intermediate position can be continuously adjusted over the entire swivel range. Thereby the two main pistons have to be locked against each other to get the intermediate position free from play. For intermediate positions of up to 90°, the stop cylinders (RZK and RZL) are to be installed as shown. For intermediate positions greater than 90°, these are to be exchanged.

Inductive proximity switches

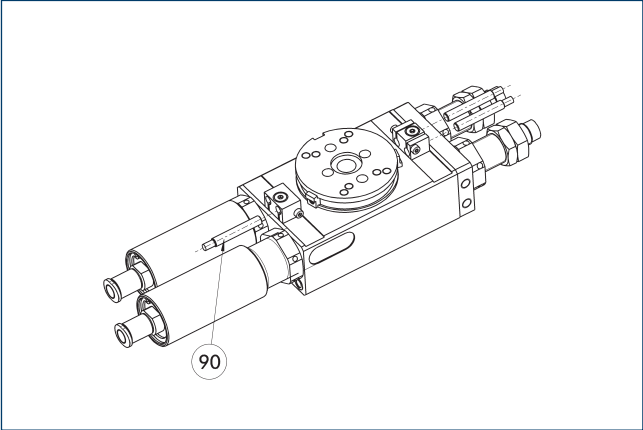

- 90 an additional proximity switch is only needed for the RZ version

The end-position monitoring (RMNS) and intermediate position monitoring (RMNZ) can be mounted directly onto the unit by using inductive proximity switches.

Description	ID	Often combined
Inductive proximity switches		
RMNS 12-G	0313042	●
RMNS 12-W	0313043	
RMNS 12-X	0313041	
RMNZ 12-G	0313045	●
RMNZ 12-W	0313046	
RMNZ 12-X	0313044	
clip for plug/socket		
CLI-M8	0301463	

- The RMNS set includes two sensors with 30 cm cable length to M8 connector, two switching cams, and a sensor bracket. The scope of delivery of the RMNZ set includes a sensor, a switching cam, and a sensor bracket. The versions -G/-W comprise a 5 m long connection cable with straight (-G) or angular (-W) plug connector to open cable end.

Electronic magnetic switch MMS

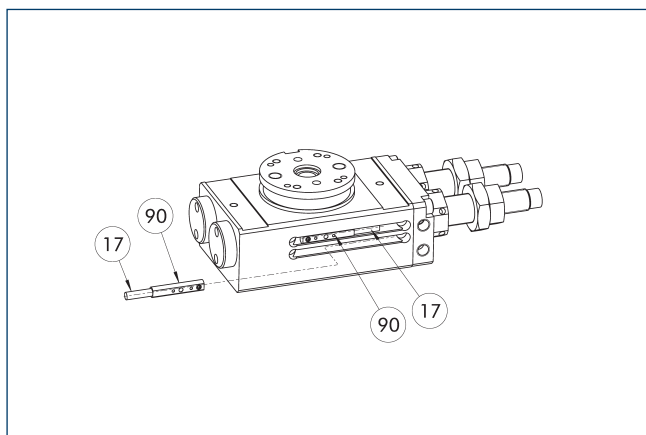

17 Cable outlet

90 Sensor MMS 22..

The end-position monitoring can be directly mounted on the unit in two C-slots by using magnetic switches.

Description	ID	Often combined
Electronic magnetic switch		
MMS 22-S-M8-PNP	0301032	
MMSK 22-S-PNP	0301034	
Electronic magnetic switches with lateral cable outlet		
MMS 22-S-M8-PNP-SA	0301042	
MMSK 22-S-PNP-SA	0301044	
Connection cables		
KA BG08-L 3P-0300-PNP	0301622	●
KA BG08-L 3P-0500-PNP	0301623	
KA BW08-L 3P-0300-PNP	0301594	
KA BW08-L 3P-0500-PNP	0301502	
clip for plug/socket		
CLI-M8	0301463	
Cable extension		
KV BW08-SG08 3P-0030-PNP	0301495	
KV BW08-SG08 3P-0100-PNP	0301496	
KV BW08-SG08 3P-0200-PNP	0301497	●
Sensor distributor		
V2-M8	0301775	●
V4-M8	0301746	
V8-M8	0301751	

① Two sensors are required per unit for monitoring two positions. On option, extension cables and sensor distributors are available. Additional product variants of the sensor, and further information and technical data can be found in the catalog chapter sensor system.

RM-F 15

Flat swivel unit



Max. permissible inertia J*

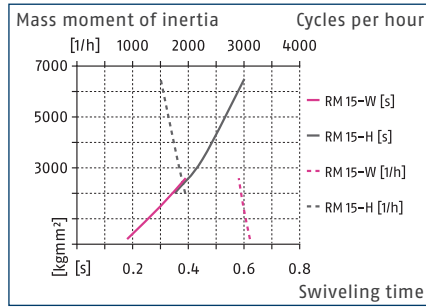

* The diagrams are valid for basic units and for applications with a vertical swivel axis as well as for absolutely centric loads with a horizontal swivel axis and with an operating pressure of 6 bar. The swiveling times per throttling have to be observed, otherwise the life time may reduce. We will be happy to help you designing other applications. In addition, the SCHUNK Design Tool Swiveling is available online.

Dimensions and maximum loads

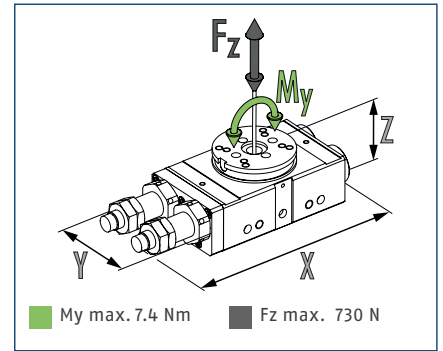

① The indicated moments and forces are statical values and may appear simultaneously. Throttling has to be done for ensuring that the rotary movement takes place without impact or bouncing. Otherwise the service life reduces.

Technical data

Description		RM 15-W	RM 15-W-RZ	RM 15-H	RM 15-H-RZ
ID		0313104	0313105	0313001	0313014
Angle of rotation	[°]	190.0	190.0	190.0	190.0
End position adjustability	[°]	90.0	90.0	90.0	90.0
Torque	[Nm]	0.76	0.76	0.76	0.76
Number of intermediate positions		none	1 x M (pneumatic)	none	1 x M (pneumatic)
Adjustability of middle position	[°]		190.0		190.0
IP protection class		40	40	40	40
Weight	[kg]	0.58	0.78	0.58	0.78
Fluid consumption (2x nom. angle)	[cm³]	9.6	9.6	9.6	9.6
Min./nom./max. operating pressure	[bar]	3/6/8	3/6/8	3/6/8	3/6/8
Min./max. ambient temperature	[°C]	5/60	5/60	5/60	5/60
Max. permissible mass moment of inertia of the set-up	[kgm²]		0.002		0.002
Repeat accuracy	[°]	0.1	0.15	0.1	0.15
Repeat accuracy (difference of both directions)	[°]		0.3		0.3
Dimensions X x Y x Z	[mm]	144 x 52 x 38	234 x 52 x 38	144 x 52 x 38	234 x 52 x 38

① For configuration of swivel modules, we recommend to use our Toolbox software, which is available online. Verifying the sizing of the selected unit is absolutely necessary, as otherwise overloading may occur.

Main view

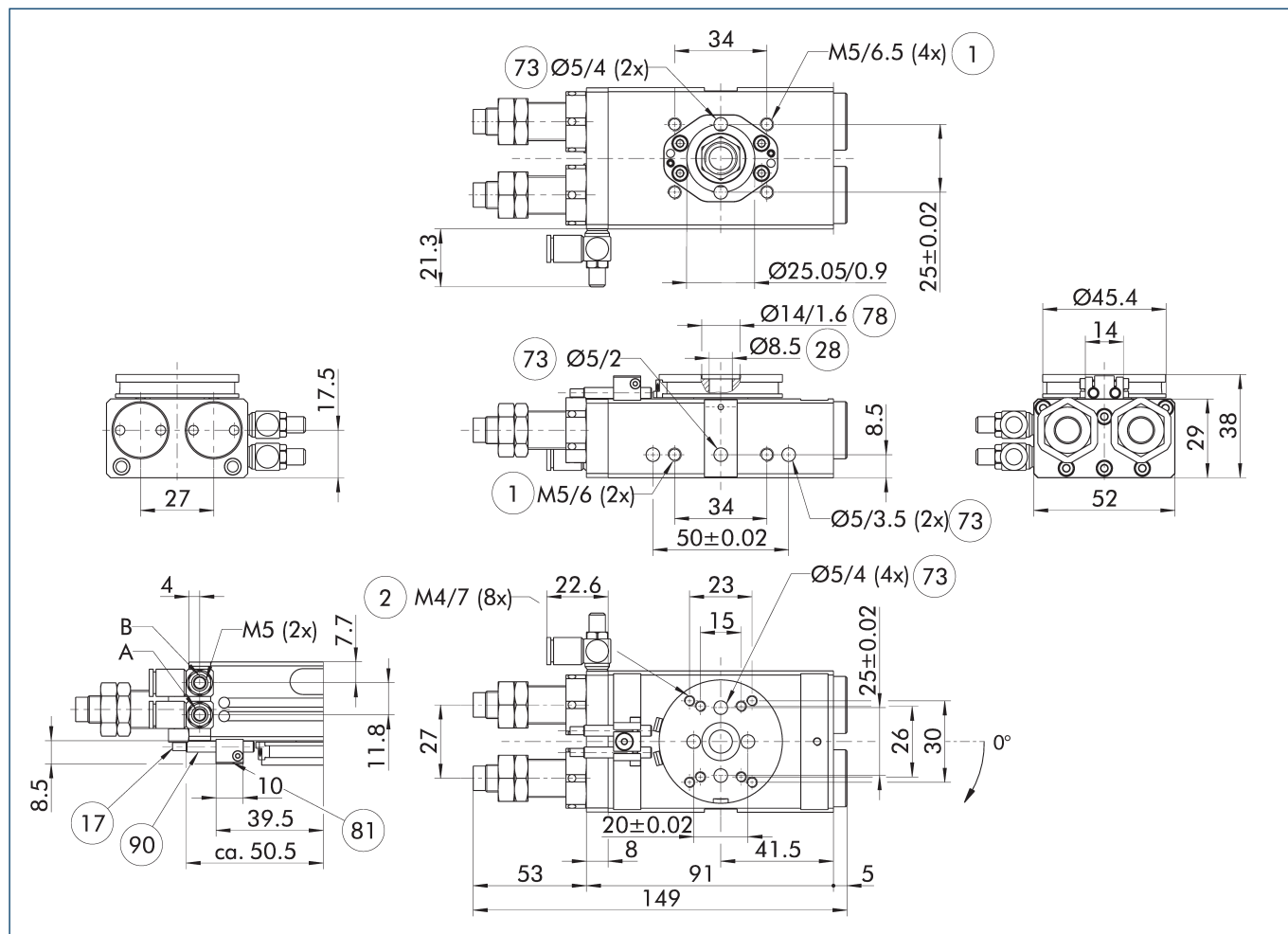

The drawing shows the unit in standard design, without considering any dimensions of the options described below.

① The SDV-P pressure maintenance valve can be used to maintain the position in the case of a loss of pressure (see "Accessories" catalog section).

A, a Main / direct connection, rotary actuator rotates clockwise

B, b Main / direct connection, rotary actuator rotates counterclockwise

① Connection swivel unit

② Attachment connection

①7 Cable outlet

②8 Through-hole

⑦3 Fit for centering pins

⑦8 Fit for centering

⑧1 Not included in the scope of delivery

⑨0 Inductive proximity switches

Intermediate position, RZ

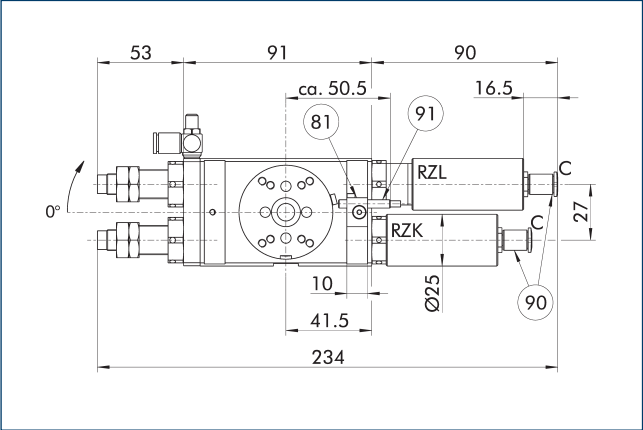

- 81 Not included in the scope of delivery

90 additional air connection "C" for intermediate position

91 Inductive proximity switches
- The intermediate position can be continuously adjusted over the entire swivel range. Thereby the two main pistons have to be locked against each other to get the intermediate position free from play. For intermediate positions of up to 90°, the stop cylinders (RZK and RZL) are to be installed as shown. For intermediate positions greater than 90°, these are to be exchanged.

Inductive proximity switches

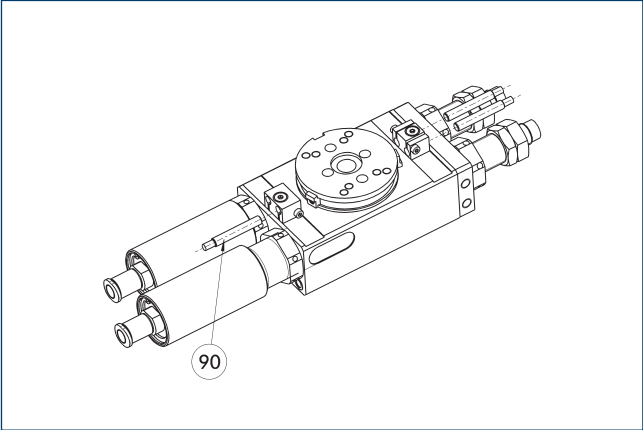

- 90 an additional proximity switch is only needed for the RZ version

The end-position monitoring (RMNS) and intermediate position monitoring (RMNZ) can be mounted directly onto the unit by using inductive proximity switches.

Description	ID	Often combined
Inductive proximity switches		
RMNS 12-G	0313042	●
RMNS 12-W	0313043	
RMNS 12-X	0313041	
RMNZ 12-G	0313045	●
RMNZ 12-W	0313046	
RMNZ 12-X	0313044	
clip for plug/socket		
CLI-M8	0301463	

- The RMNS set includes two sensors with 30 cm cable length to M8 connector, two switching cams, and a sensor bracket. The scope of delivery of the RMNZ set includes a sensor, a switching cam, and a sensor bracket. The versions -G/-W comprise a 5 m long connection cable with straight (-G) or angular (-W) plug connector to open cable end.

Electronic magnetic switch MMS

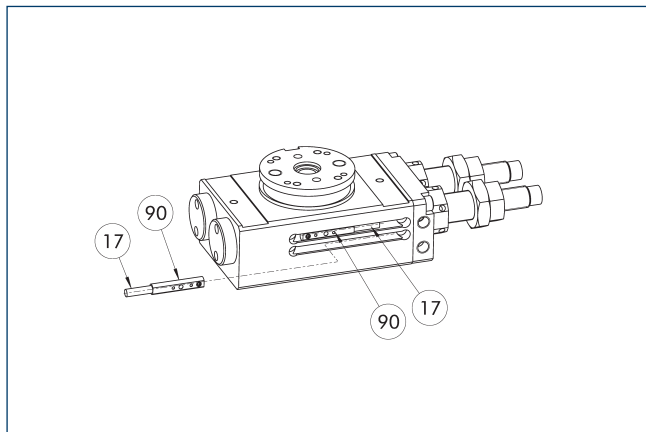

17 Cable outlet

90 Sensor MMS 22..

The end-position monitoring can be directly mounted on the unit in two C-slots by using magnetic switches.

Description	ID	Often combined
Electronic magnetic switch		
MMS 22-S-M8-PNP	0301032	
MMSK 22-S-PNP	0301034	
Electronic magnetic switches with lateral cable outlet		
MMS 22-S-M8-PNP-SA	0301042	
MMSK 22-S-PNP-SA	0301044	
Connection cables		
KA BG08-L 3P-0300-PNP	0301622	●
KA BG08-L 3P-0500-PNP	0301623	
KA BW08-L 3P-0300-PNP	0301594	
KA BW08-L 3P-0500-PNP	0301502	
clip for plug/socket		
CLI-M8	0301463	
Cable extension		
KV BW08-SG08 3P-0030-PNP	0301495	
KV BW08-SG08 3P-0100-PNP	0301496	
KV BW08-SG08 3P-0200-PNP	0301497	●
Sensor distributor		
V2-M8	0301775	●
V4-M8	0301746	
V8-M8	0301751	

① Two sensors are required per unit for monitoring two positions. On option, extension cables and sensor distributors are available. Additional product variants of the sensor, and further information and technical data can be found in the catalog chapter sensor system.

RM-F 21

Flat swivel unit



Max. permissible inertia J*

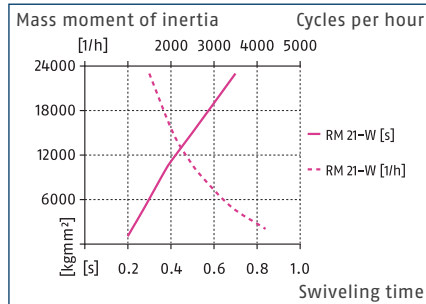

* The diagrams are valid for basic units and for applications with a vertical swivel axis as well as for absolutely centric loads with a horizontal swivel axis and with an operating pressure of 6 bar. The swiveling times per throttling have to be observed, otherwise the life time may reduce. We will be happy to help you designing other applications. In addition, the SCHUNK Design Tool Swiveling is available online.

Dimensions and maximum loads

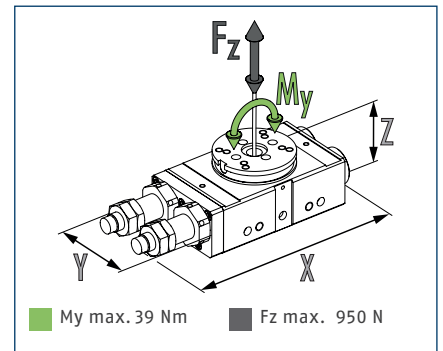

① The indicated moments and forces are static values and may appear simultaneously. Throttling has to be done for ensuring that the rotary movement takes place without impact or bouncing. Otherwise the service life reduces.

Technical data

Description		RM 21-W	RM 21-W-RZ
ID		0313002	0313015
Angle of rotation	[°]	190.0	190.0
End position adjustability	[°]	90.0	90.0
Torque	[Nm]	1.9	1.9
Number of intermediate positions		none	1 x M (pneumatic)
Adjustability of middle position	[°]		190.0
IP protection class		40	40
Weight	[kg]	1.16	1.6
Fluid consumption (2x nom. angle)	[cm³]	23.8	23.8
Min./nom./max. operating pressure	[bar]	3/6/8	3/6/8
Min./max. ambient temperature	[°C]	5/60	5/60
Max. permissible mass moment of inertia of the set-up	[kgm²]		0.02
Repeat accuracy	[°]	0.088	0.12
Repeat accuracy (difference of both directions)			0.25
Dimensions X x Y x Z	[mm]	183 x 65 x 48	294 x 65 x 48

① For configuration of swivel modules, we recommend to use our Toolbox software, which is available online. Verifying the sizing of the selected unit is absolutely necessary, as otherwise overloading may occur.

Main view

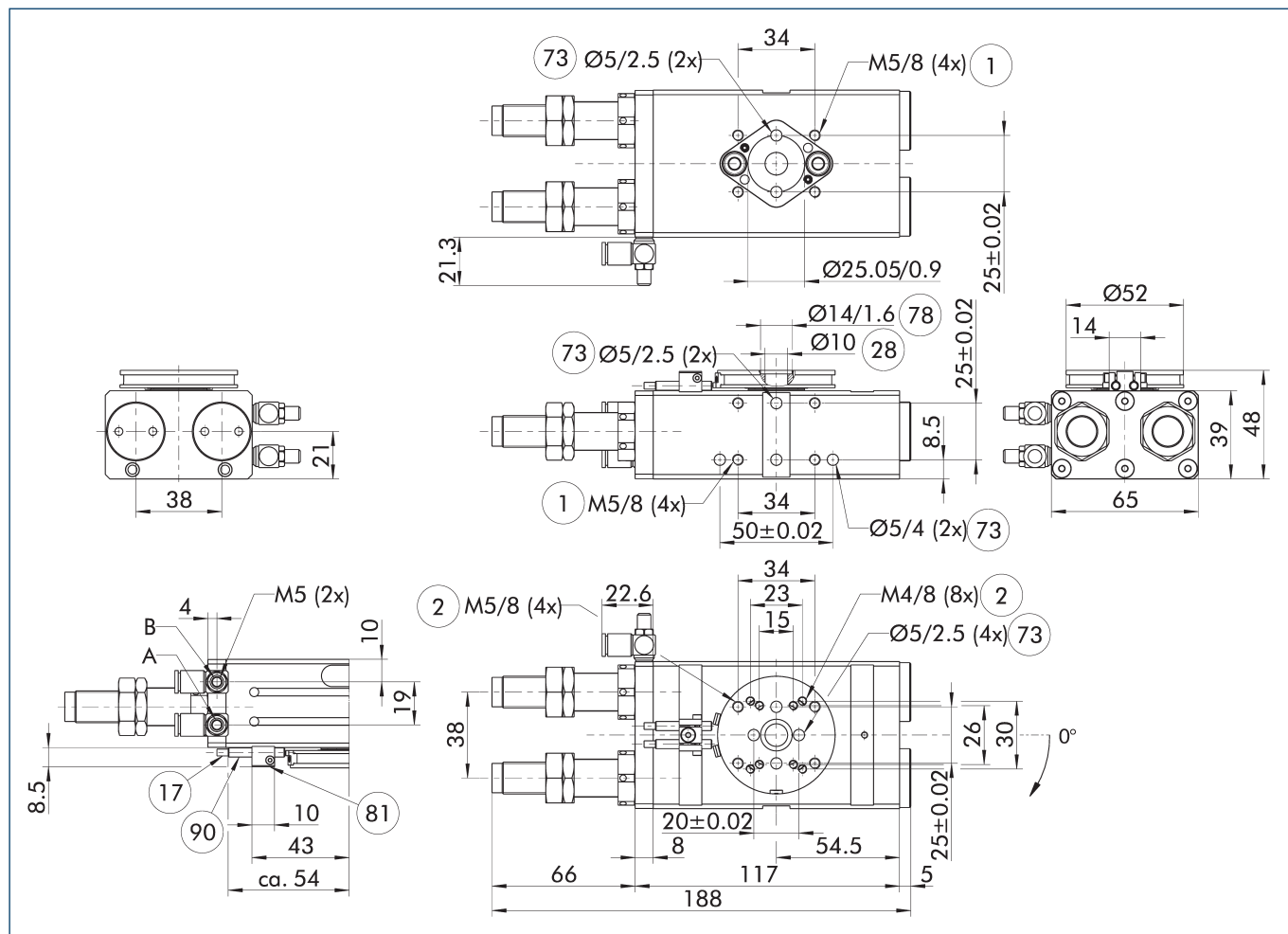

The drawing shows the unit in standard design, without considering any dimensions of the options described below.

- ① The SDV-P pressure maintenance valve can be used to maintain the position in the case of a loss of pressure (see "Accessories" catalog section).

A, a Main / direct connection, rotary actuator rotates clockwise

B, b Main / direct connection, rotary actuator rotates counterclockwise

- ① Connection swivel unit
- ② Attachment connection

①7 Cable outlet

②8 Through-hole

⑦3 Fit for centering pins

⑦8 Fit for centering

⑧1 Not included in the scope of delivery

⑨0 Inductive proximity switches

Intermediate position, RZ

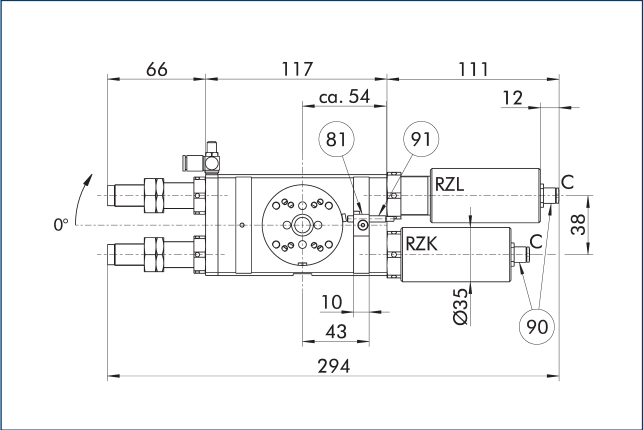

- 81 Not included in the scope of delivery

90 additional air connection "C" for intermediate position

91 Inductive proximity switches
- The intermediate position can be continuously adjusted over the entire swivel range. Thereby the two main pistons have to be locked against each other to get the intermediate position free from play. For intermediate positions of up to 90°, the stop cylinders (RZK and RZL) are to be installed as shown. For intermediate positions greater than 90°, these are to be exchanged.

Inductive proximity switches

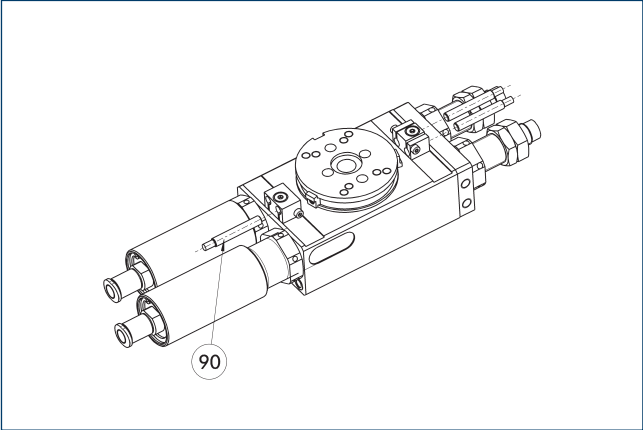

- 90 an additional proximity switch is only needed for the RZ version

The end-position monitoring (RMNS) and intermediate position monitoring (RMNZ) can be mounted directly onto the unit by using inductive proximity switches.

Description	ID	Often combined
Inductive proximity switches		
RMNS 12-G	0313042	●
RMNS 12-W	0313043	
RMNS 12-X	0313041	
RMNZ 12-G	0313045	●
RMNZ 12-W	0313046	
RMNZ 12-X	0313044	
clip for plug/socket		
CLI-M8	0301463	

- The RMNS set includes two sensors with 30 cm cable length to M8 connector, two switching cams, and a sensor bracket. The scope of delivery of the RMNZ set includes a sensor, a switching cam, and a sensor bracket. The versions -G/-W comprise a 5 m long connection cable with straight (-G) or angular (-W) plug connector to open cable end.

Electronic magnetic switch MMS

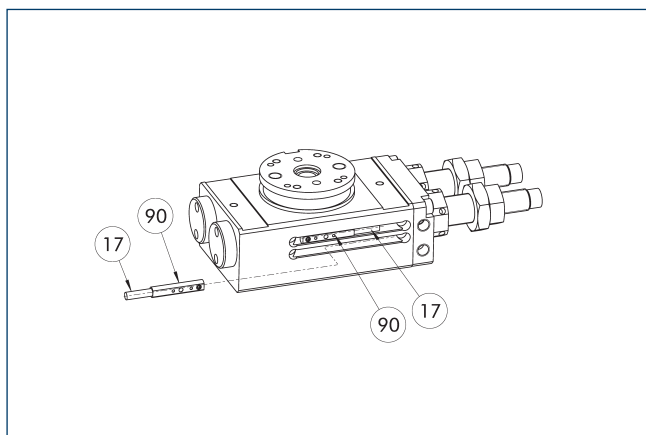

17 Cable outlet

90 Sensor MMS 22..

The end-position monitoring can be directly mounted on the unit in two C-slots by using magnetic switches.

Description	ID	Often combined
Electronic magnetic switch		
MMS 22-S-M8-PNP	0301032	
MMSK 22-S-PNP	0301034	
Electronic magnetic switches with lateral cable outlet		
MMS 22-S-M8-PNP-SA	0301042	
MMSK 22-S-PNP-SA	0301044	
Connection cables		
KA BG08-L 3P-0300-PNP	0301622	●
KA BG08-L 3P-0500-PNP	0301623	
KA BW08-L 3P-0300-PNP	0301594	
KA BW08-L 3P-0500-PNP	0301502	
clip for plug/socket		
CLI-M8	0301463	
Cable extension		
KV BW08-SG08 3P-0030-PNP	0301495	
KV BW08-SG08 3P-0100-PNP	0301496	
KV BW08-SG08 3P-0200-PNP	0301497	●
Sensor distributor		
V2-M8	0301775	●
V4-M8	0301746	
V8-M8	0301751	

① Two sensors are required per unit for monitoring two positions. On option, extension cables and sensor distributors are available. Additional product variants of the sensor, and further information and technical data can be found in the catalog chapter sensor system.



SCHUNK GmbH & Co. KG
Spann- und Greiftechnik

Bahnhofstr. 106 - 134
D-74348 Lauffen/Neckar
Tel. +49-7133-103-0
Fax +49-7133-103-2399
info@de.schunk.com
schunk.com

Folgen Sie uns | *Follow us*

